

- Legend:**
- City Boundary
  - Proposed Development Boundary
  - Proposed Road Development
  - Air Quality Receptors

Son áireamh tá sonraíocht Shuirbhíreachtí Ordánais Éireann arna áitirgeadh fust Cheadúnas OSI Uimh. 2010/18CCMA/Comhairle Contae na Gaillimhe. Sírtaíonn áitirgeadh neamhdaraithe cóipeacht Shuirbhíreachtí Ordánais Éireann agus Rialtas na hÉireann. © Suirbhíreacht Ordánais Éireann, 2010.

© Suirbhíreacht Ordánais Éireann. Gach ceart ar chosaint. Uimhir cheadúnais 2010/18CCMA/Comhairle Contae na Gaillimhe.

Includes Ordnance Survey Ireland data reproduced under OSI Licence number 2010/18CCMA/Galway County Council. Unauthorised reproduction infringes Ordnance Survey Ireland and Government of Ireland copyright. © Ordnance Survey Ireland, 2010.

© Ordnance Survey Ireland. All rights reserved. Licence number 2010/18CCMA/Galway County Council.

**Clients**

**Key Plan**

**Consultant**

Corporate House  
City East Business Park  
Ballybrit, Galway, Ireland.

Tel +353 (0)91 460675  
www.N6GalwayCity.ie  
www.arup.ie

**Job Title**  
N6 Galway City Ring Road

**Scale**  
1:10,000 @ A3

**Date:**  
September 2018

Issue	Date	By	Chkd	Appd
I1	28/09/2018	KJ	MH	EMC

**Drawing Title**  
Air Quality Receptors

**Sheet 01 of 07**

**For Information**

Job No <b>233985</b>	Drawing No <b>Figure 16.1.01</b>	Issue <b>11</b>
-------------------------	-------------------------------------	--------------------

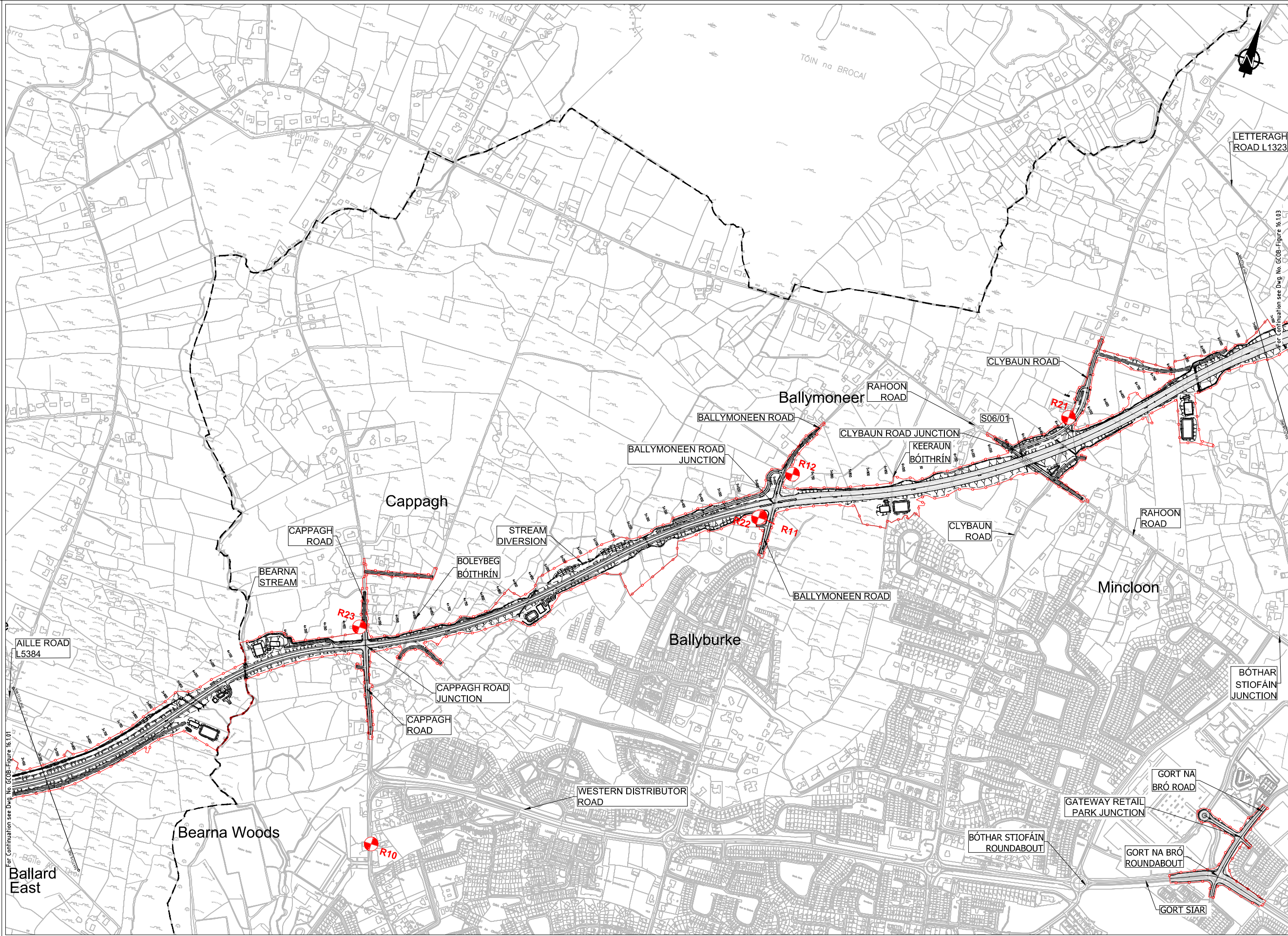

- Legend:**
- City Boundary
  - Proposed Development Boundary
  - Proposed Road Development
  - Air Quality Receptors

Son áireamh tá sonraíocht Shuirbhíreachtú Ordnáis Éireann arna aistriúchadh fúis Cheadúnas OSI Uimh. 2010/18CCMA/Comhairle Contae na Gaillimhe. Sírúinn aistriúchadh neamhdhírreachtú cóscheart Shuirbhíreachtú Ordnáis Éireann agus Rialtas na hÉireann. © Suirbhíreachtú Ordnáis Éireann, 2010.

Includes Ordnance Survey Ireland data reproduced under OSI Licence number 2010/18CCMA/Comhairle Contae na Gaillimhe. Unauthorised reproduction infringes Ordnance Survey Ireland and Government of Ireland copyright. © Ordnance Survey Ireland, 2010.

© Ordnance Survey Ireland. All rights reserved. Licence number 2010/18CCMA/Galway County Council.

**Clients**

**Key Plan**

**Consultant**

Corporate House  
City East Business Park  
Ballybrit, Galway, Ireland.

Tel +353 (0)91 460675  
www.N6GalwayCity.ie  
www.arup.ie

**Job Title**  
N6 Galway City Ring Road

**Scale**  
1:10,000 @ A3

**Date:**  
September 2018

Issue	Date	By	Chkd	Appd
I1	28/09/2018	KJ	MH	EMC

**Drawing Title**  
Air Quality Receptors

**Sheet 02 of 07**

**For Information**

Job No: 233985  
Drawing No: Figure 16.1.02  
Issue: 11

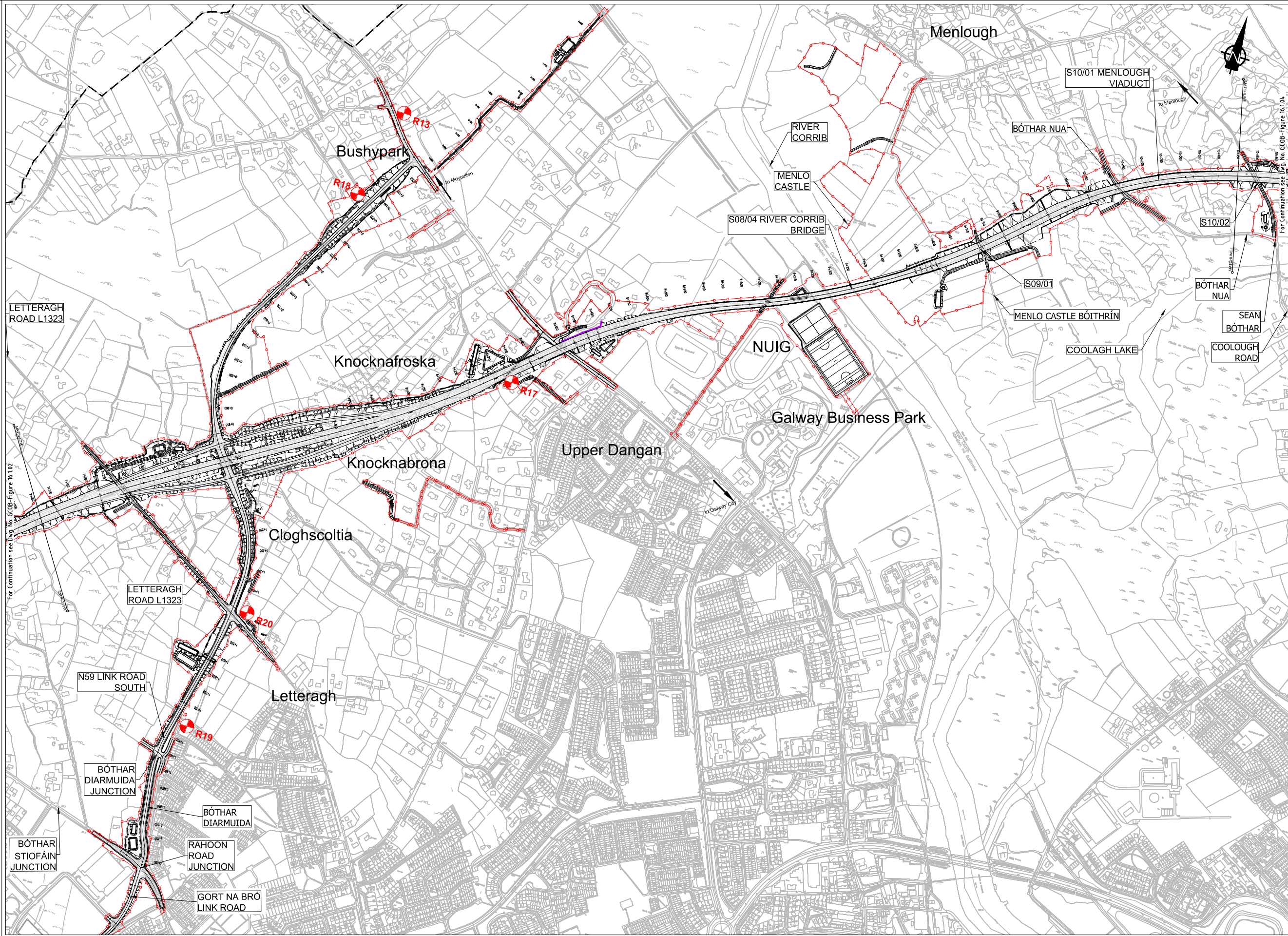

- Legend:**
- City Boundary
  - - - Proposed Development Boundary
  - Proposed Road Development
  - NO Air Quality Receptors

San áireamh tá sonraíocht Shuirbhíreacha Ordánais Éireann arna atáirgeadh fós Cheadúnas OSI Uimh. 2010/18CCMA/Comhairle Contae na Gaillimhe. Sírúinn atáirgeadh neamhdírúithe cóipeacht Shuirbhíreacha Ordánais Éireann agus Rialtas na hÉireann. © Suirbhíreacha Ordánais Éireann, 2010.

© Suirbhíreacha Ordánais Éireann. Gach ceart ar chosaint. Uimhir cheadúnais 2010/18CCMA/Comhairle Contae na Gaillimhe.

Includes Ordnance Survey Ireland data reproduced under OSI Licence number 2010/18CCMA/Galway County Council. Unauthorised reproduction infringes Ordnance Survey Ireland and Government of Ireland copyright. © Ordnance Survey Ireland, 2010.

© Ordnance Survey Ireland. All rights reserved. Licence number 2010/18CCMA/Galway County Council.

**Clients**

Comhairle Chontae na Gaillimhe  
Galway County Council

**Galway City Transport Project**

**An Roipín Iompair Turasóireachta agus Spóirt**

**TII**

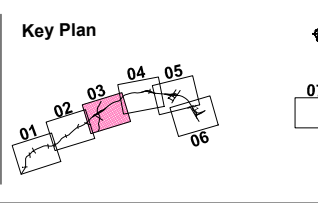

**Consultant**

**ARUP**

Corporate House  
City East Business Park  
Ballybrit, Galway, Ireland.

Tel +353 (0)91 460675  
www.N6GalwayCity.ie  
www.arup.ie

**Job Title**  
N6 Galway City Ring Road

**Scale**  
1:10,000 @ A3

**Date:**  
September 2018

Issue	Date	By	Chkd	Appd
I1	28/09/2018	KJ	MH	EMC

**Drawing Title**  
Air Quality Receptors

**Sheet 03 of 07**

**Drawing Status**

**For Information**

Job No: **233985**  
Drawing No: **Figure 16.1.03**  
Issue: **11**

Legend:

- City Boundary
- Proposed Development Boundary
- Proposed Road Development
- Air Quality Receptors

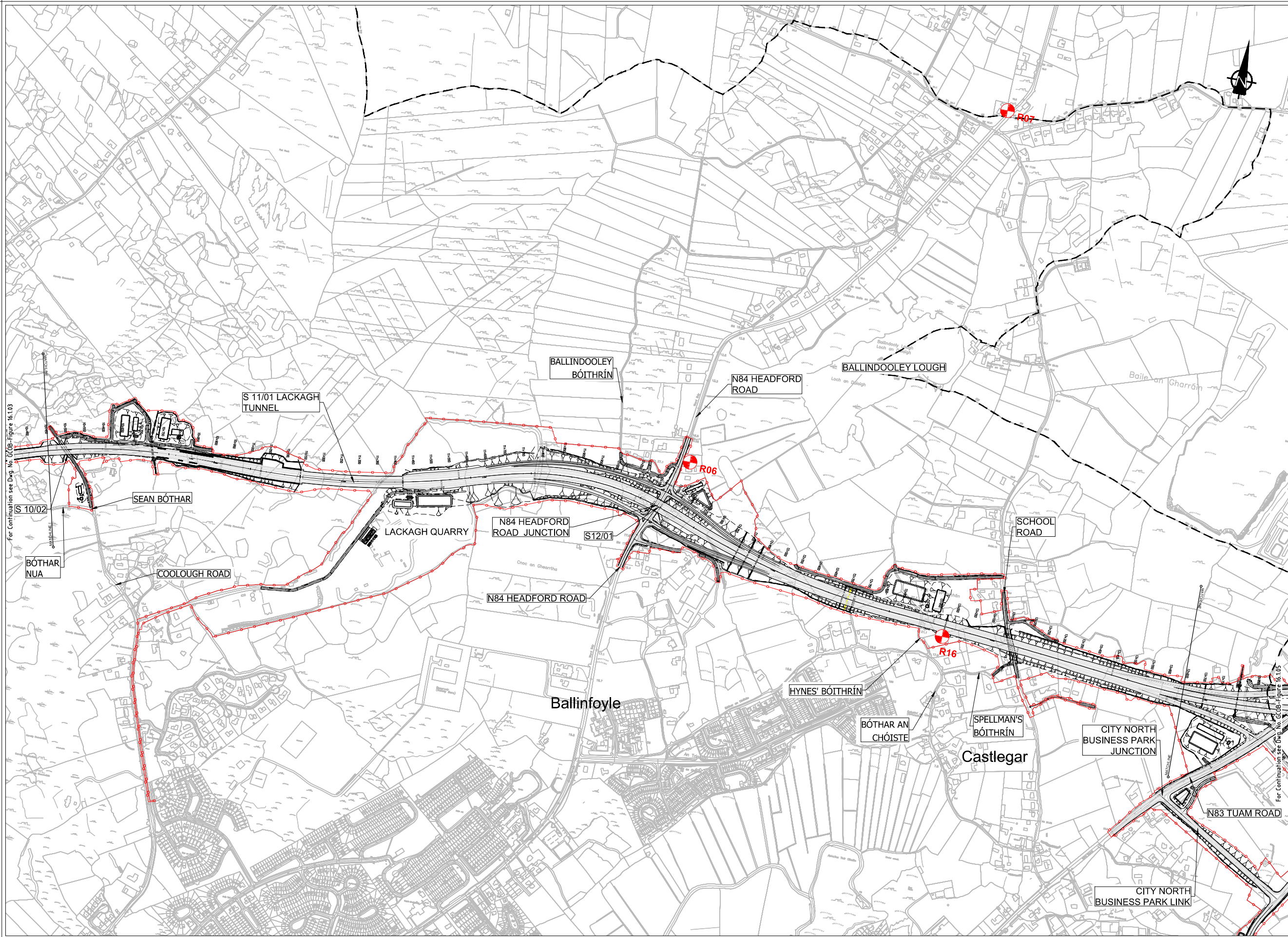

Son áireamh tá sonraíocht Shuirbhíreachtú Ordnáis Éireann arna aistriú go dtí físeánáis OSI Uimh. 2010/18CCMA/Comhairle Contae na Gaillimhe. Sírtaíonn aistriú na n-áireamh seo Shuirbhíreachtú Ordnáis Éireann agus Rialtas na hÉireann. © Suirbhíreachtú Ordnáis Éireann, 2010.

Includes Ordnance Survey Ireland data reproduced under OSI Licence number 2010/18CCMA/Galway County Council. Unauthorised reproduction infringes Ordnance Survey Ireland and Government of Ireland copyright. © Ordnance Survey Ireland, 2010.

© Ordnance Survey Ireland. All rights reserved. Licence number 2010/18CCMA/Galway County Council.

Clients

Key Plan

Consultant

Corporate House  
City East Business Park  
Ballybrit, Galway, Ireland.

Tel +353 (0)91 460675  
www.N6GalwayCity.ie  
www.arup.ie

Job Title  
N6 Galway City Ring Road

Scale  
1:10,000 @ A3

Date  
September 2018

Issue	Date	By	Chkd	Appd
I1	28/09/2018	KJ	MH	EMC

Drawing Title  
Air Quality Receptors

Sheet 04 of 07

Drawing Status

For Information

Job No 233985	Drawing No Figure 16.1.04	Issue 11
------------------	------------------------------	-------------

- Legend:**
- City Boundary
  - Proposed Development Boundary
  - Proposed Road Development
  - Air Quality Receptors

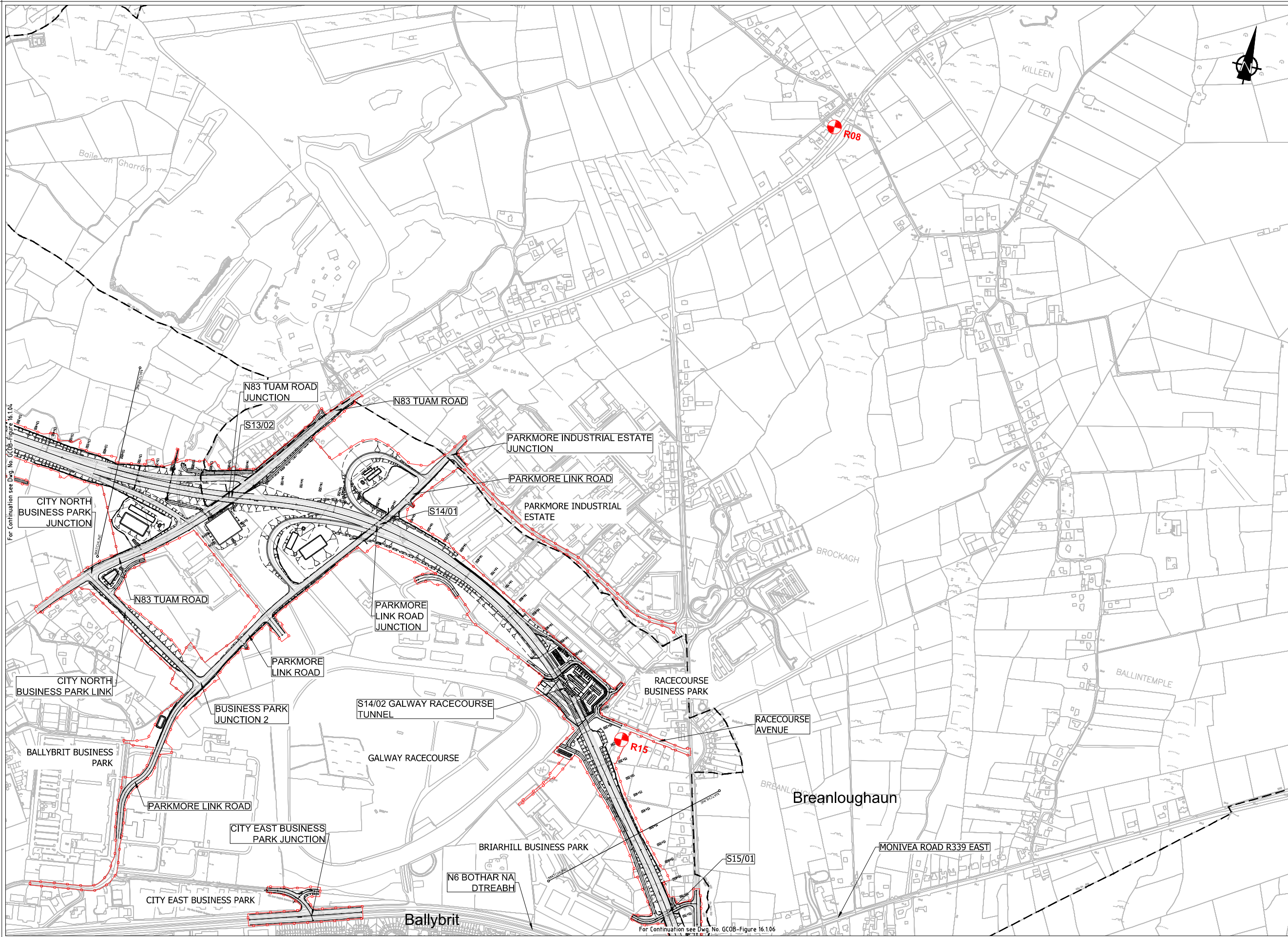

For Continuation see Dwg. No. GC08-Figure 16.1.04

For Continuation see Dwg. No. GC08-Figure 16.1.06

Son áireamh tá sonraíocht Shuirbhíreacht Ordnáis Éireann arna áitirgeadh fós Cheadúnas OSI Uimh. 2010/18CCMA/Comhairle Contae na Gaillimhe. Sírúinn áitirgeadh neamhidarthaí cóscheart Shuirbhíreacht Ordnáis Éireann agus Rialtas na hÉireann. © Suirbhíreacht Ordnáis Éireann, 2010.

© Suirbhíreacht Ordnáis Éireann. Gach ceart ar chosaint. Uimhir cheadúnais 2010/18CCMA/Comhairle Contae na Gaillimhe.

Includes Ordnance Survey Ireland data reproduced under OSI Licence number 2010/18CCMA/Galway County Council. Unauthorised reproduction infringes Ordnance Survey Ireland and Government of Ireland copyright. © Ordnance Survey Ireland, 2010.

© Ordnance Survey Ireland. All rights reserved. Licence number 2010/18CCMA/Galway County Council.

Clients

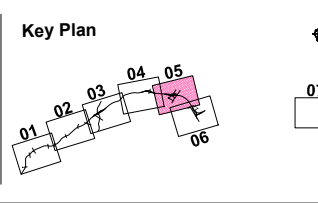

Consultant

Corporate House  
City East Business Park  
Ballybrit, Galway, Ireland.

Tel +353 (0)91 460675  
www.N6GalwayCity.ie  
www.arup.ie

Job Title  
**N6 Galway City Ring Road**

Scale  
1:10,000 @ A3

Date  
September 2018

Issue	Date	By	Chkd	Appd
I1	28/09/2018	KJ	MH	EMC

Drawing Title  
Air Quality Receptors

Sheet 05 of 07

Drawing Status

**For Information**

Job No <b>233985</b>	Drawing No <b>Figure 16.1.05</b>	Issue <b>11</b>
-------------------------	-------------------------------------	--------------------

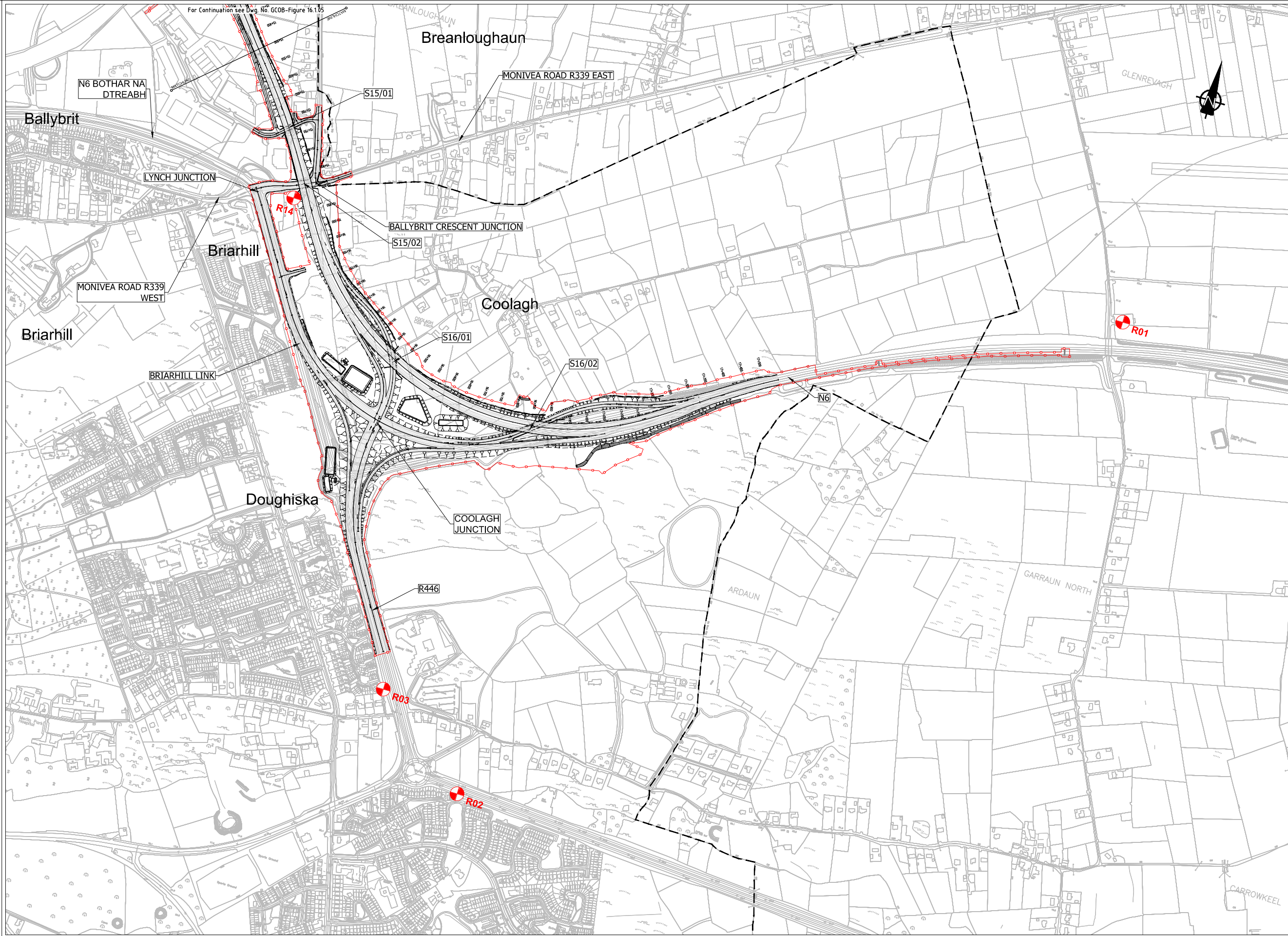

- Legend:**
- City Boundary
  - - - Proposed Development Boundary
  - ▨ Proposed Road Development
  - ⊗ NO Air Quality Receptors

Son áiríamh tá sonraíocht Shuirbhíreacht Ordnáis Éireann arna áirígeadh fós Cheadúnas OSI Uimh. 2010/18CCMA/Comhairle Contae na Gaillimhe. Sírúinn áirígeadh neamhdíríaithe cóipeacht Shuirbhíreacht Ordnáis Éireann agus Rialtas na hÉireann. © Suirbhíreacht Ordnáis Éireann, 2010.

Includes Ordnance Survey Ireland data reproduced under OSI Licence number 2010/18CCMA/Galway County Council. Unauthorised reproduction infringes Ordnance Survey Ireland and Government of Ireland copyright. © Ordnance Survey Ireland, 2010.

Do not scale  
J:\233000\233985-004\_Internal\4-02 Drawings\4-02-6 Environmental\6.8 Air Quality\Figures 16.1.01 to 16.1.07\_11.dwg

**Clients**

Comhairle Chontae na Gaillimhe  
Galway County Council

An Roinn Iompair  
Turasóireachta agus Spóirt  
Department Transport, Tourism and Sport

TII  
Transport Infrastructure Ireland

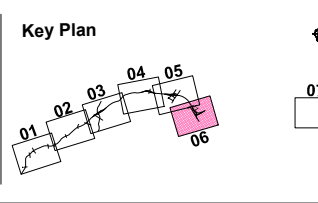

**Consultant**

**ARUP**

Corporate House  
City East Business Park  
Ballybrit, Galway, Ireland.

Tel +353 (0)91 460675  
www.N6GalwayCity.ie  
www.arup.ie

**Job Title**  
N6 Galway City Ring Road

**Scale**  
1:10,000 @ A3

**Date:**  
September 2018

Issue	Date	By	Chkd	Appd
I1	28/09/2018	KJ	MH	EMC

**Drawing Title**  
Air Quality Receptors

**Sheet 06 of 07**

**For Information**

Job No: 233985  
Drawing No: Figure 16.1.06  
Issue: 11

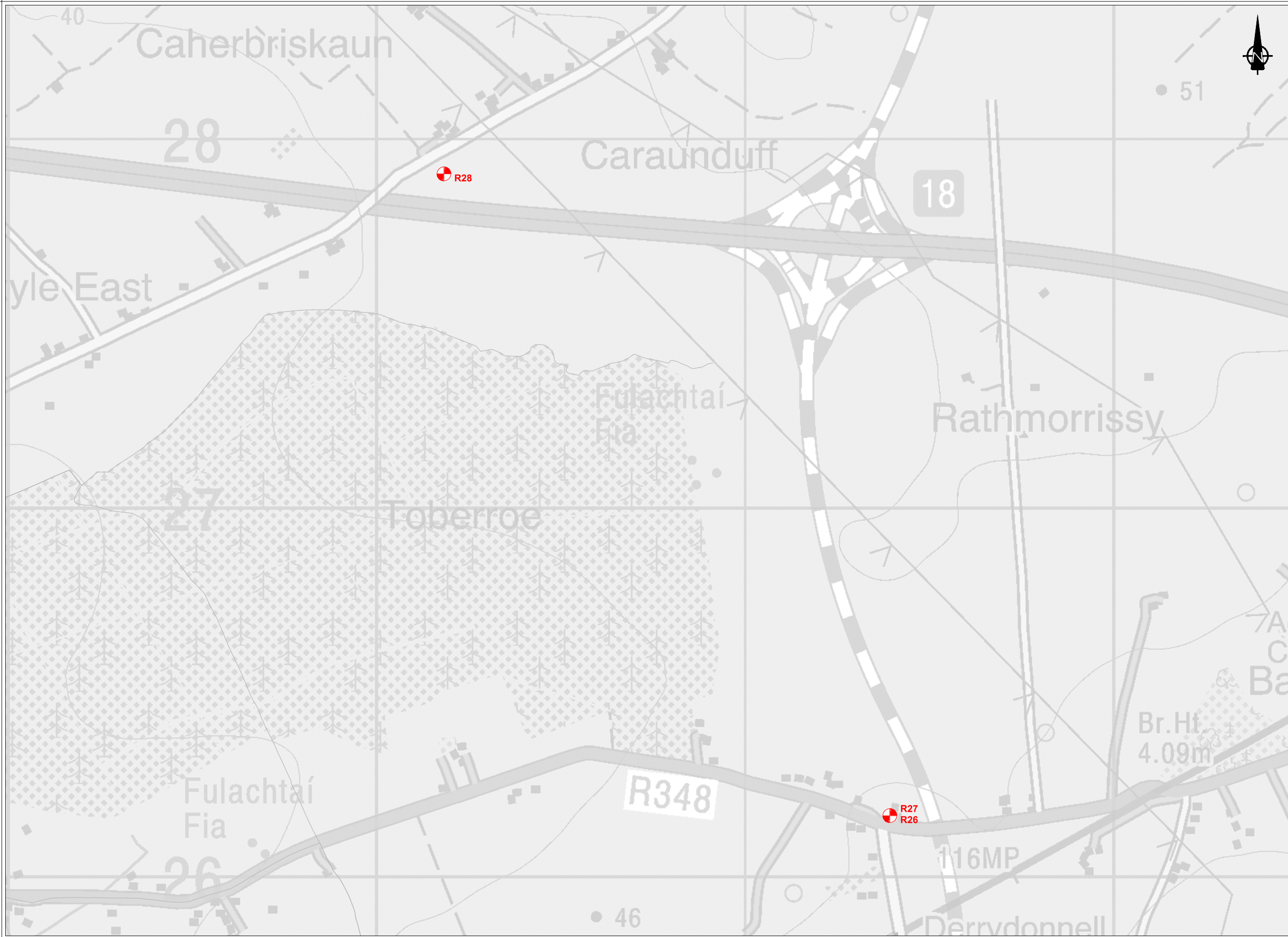

- Legend:**
- City Boundary
  - Proposed Development Boundary
  - Proposed Road Development
  - Air Quality Receptors



Son áireamh tá sonraíocht Shuirbhíreachtí Ordánais Éireann arna atáirgeadh fust Cheadúnas OSI Uimh. 2010/18CCMA/Comhairle Contae na Gaillimhe. Sírtaíonn atáirgeadh neamhdaraithe cóipeacht Shuirbhíreachtí Ordánais Éireann agus Rialtas na hÉireann. © Suirbhíreacht Ordánais Éireann, 2010.

© Suirbhíreacht Ordánais Éireann. Gach ceart ar chosaint. Uimhir cheadúnais 2010/18CCMA/Comhairle Contae na Gaillimhe.

Includes Ordnance Survey Ireland data reproduced under OSI Licence number 2010/18CCMA/Galway County Council. Unauthorised reproduction infringes Ordnance Survey Ireland and Government of Ireland copyright. © Ordnance Survey Ireland, 2010.

© Ordnance Survey Ireland. All rights reserved. Licence number 2010/18CCMA/Galway County Council.

**Clients**

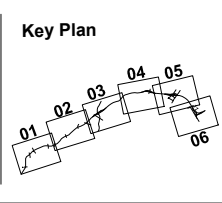

**Consultant**

Corporate House  
City East Business Park  
Ballybrit, Galway, Ireland.

Tel +353 (0)91 460675  
www.N6GalwayCity.ie  
www.arup.ie

**Job Title**  
N6 Galway City Ring Road

**Scale**  
1:10,000 @ A3

**Date:**  
September 2018

Issue	Date	By	Chkd	Appd
I1	28/09/2018	KJ	MH	EMC

**Drawing Title**  
Air Quality Receptors

**Sheet 07 of 07**

**Drawing Status**

**For Information**

Job No <b>233985</b>	Drawing No <b>Figure 16.1.07</b>	Issue <b>11</b>
-------------------------	-------------------------------------	--------------------